

Installation instructions

Important - Save for the local electrical inspector's use.

EWI 457.1

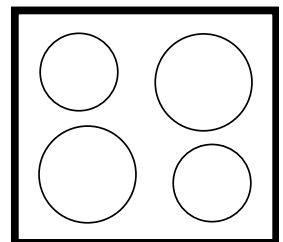

For your information...

Be sure to read the information in this manual carefully before you install the cook top.

Please keep this manual in a safe place and pass it on to future owners for their information and safety.

The following symbols are used in this operating manual:

 The warning triangle will alert you about possible health risks or things that can cause potential damage to your appliance.

 You'll find useful hints and information when you see this symbol.

Warranty

This warranty is extended to the original purchaser and succeeding owners for products purchased for ordinary home use. It does not cover its use in commercial situation. Should the appliance be sold by the original purchaser during the warranty period, the new owner continued to be protected until the expiration date of the original purchaser's warranty period. Save your dated receipt or other evidence of the installation/occupancy date. Proof of original purchase date is needed to obtain service under warranty. The warranty applies even if the owner should move during the warranty period.

Küppersbusch does not assume any responsibility for consequential or incidental damages. This warranty provides you with certain legal rights. You may also have other rights which may vary from state to state.

What Is Covered

For one full year from the date of the original purchase, we will provide parts, service and labor in your home to repair or replace any part of the cook top that fails because of a defect in materials or workmanship. This service is provided free of charge. All warranty service will be provided by an authorized technician during normal business hours.

What Isn't Covered

- Service by an unauthorized agency will not be reimbursed. Likewise, the warranty doesn't cover any damage or repairs due to service performed by an unauthorized agency, or by the use of unauthorized parts.
- Service visits to teach you how to use the appliance.
- Service visits to correct the installation. You are responsible for providing electrical wiring and other connecting facilities.
- Reset circuit breakers or replace home fuses.
- Damage resulting from accident, alteration, misuse, improper installation, abuse or installation not in accordance with local electrical codes, or improper storage of the appliance.
- Repairs due to other than normal household use.

Disposing of the packaging and the old appliance

Be sure to dispose of the transport packaging properly. Disposal should not have a negative impact on the environment. Recycling the packaging saves raw materials and reduces the amount of waste.

Be sure to dispose of your old appliance properly, as well. Even if it can no longer be used, it still contains useful materials. Before discarding an old appliance, disconnect the power cord and remove the door to prevent it from becoming a hazard.

Contents

Safety instructions	3
General	3
Installation conditions	3
Dimensions and distances	3
Installation dimensions	4
Several cooktops side by side	4
Electrical connection	4
Installation	5
Special case: Installing in a stone work surface	6

For technical information and/or replacement parts, please contact the
Küppersbusch Customer Care line
at
1-800-459-0844
For the most efficient assistance, please have the Model and Serial numbers for the appliance available.

The following symbols are used in this installation manual:

 The warning triangle will alert you about possible health risks or things that can cause potential damage to your appliance.

 You'll find useful hints and information when you see this symbol.

Safety instructions

- Turn off the power source before installing the cooking surface.
- Do not operate the appliance until it has been properly installed within cabinetry or into an opening in the countertop!
- Only qualified personnel should perform installations and repairs on electrical appliances. Do not repair or replace any part of the appliance yourself unless specifically recommended in this manual. Don't put your safety at risk.
- The glass ceramic surface is very tough and can easily withstand light to medium blows and loads distributed over large areas. You should avoid dropping concentrated loads like spice bottles onto the surface. The impact of such items can damage the cooking surface.
- If the cooking surface becomes fractured or cracked, quit using it immediately. Disconnect the power source and call Customer Service.
- The connecting cable must not come in contact with the hot cooking surface.

General

- Due to the installation dept of 200 mm (7-7/8") the induction hob cannot be installed above an standard application!
- To remove the glass ceramic surface, lift it laterally – never lift it by the front panel!
- Do not use a screw driver to lift the appliance out of the opening or you could damage the frame of the appliance. Instead, press the appliance out from the bottom of the opening in the countertop or cabinetry.

Installation conditions

- Make sure the plastic finish or the veneer of the built-in kitchen furniture has a heat-resistant adhesive (100 °C / 210 °F).
- The countertop must be perfectly horizontal and the opening for the appliance must be cleanly cut.
- Make sure there aren't any cross bars underneath the cut-out for the appliance. Make any necessary adjustments.
- Each time the appliance is removed from the countertop, be sure to replace the seals.
- Make sure there is an oven or a shelf installed under the cooktop.

Dimensions and distances

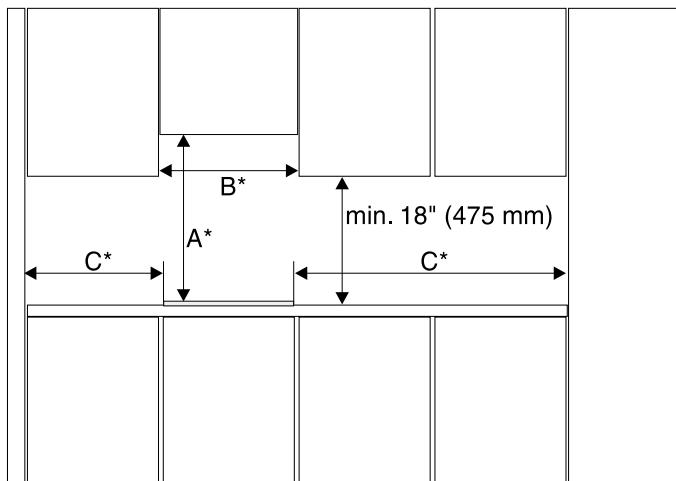

Concerning A*: A = 30 inches minimum clearance between the top of the cooking surface and the bottom of an unprotected wood or metal cabinet or A = 24 inches minimum when bottom of wood or metal cabinet is protected by not less than 1/4-inch-thick flame-retardant millboard covered with no less than No. 28 MSG sheet steel, 0.015-inch-thick stainless steel, 0.024-inch-thick aluminium, or 0.020-inch-thick copper.

Hoods above the cook top should be at least 650 mm (26") away from the cook top.

Concerning B*: Minimum distance corresponds to the width of the appliance.

To eliminate the risk of burns or fire by reaching over heated surface units, do not locate cabinet storage space above the surface units. If cabinet storage must be provided, the risk can be reduced by installing a range hood that projects horizontally a minimum of 5 inches beyond the bottom of the cabinets.

Concerning C*: This appliance can be mounted with two sides to a wall or a cupboard side with a distance of at least 40 mm (1-9/16"). The third side may only be positioned next to an appliance of equal height.

We recommend a horizontal distance between the appliance and mounted cupboards of at least 300 mm (12") for ergonomical reasons.

Installation dimensions

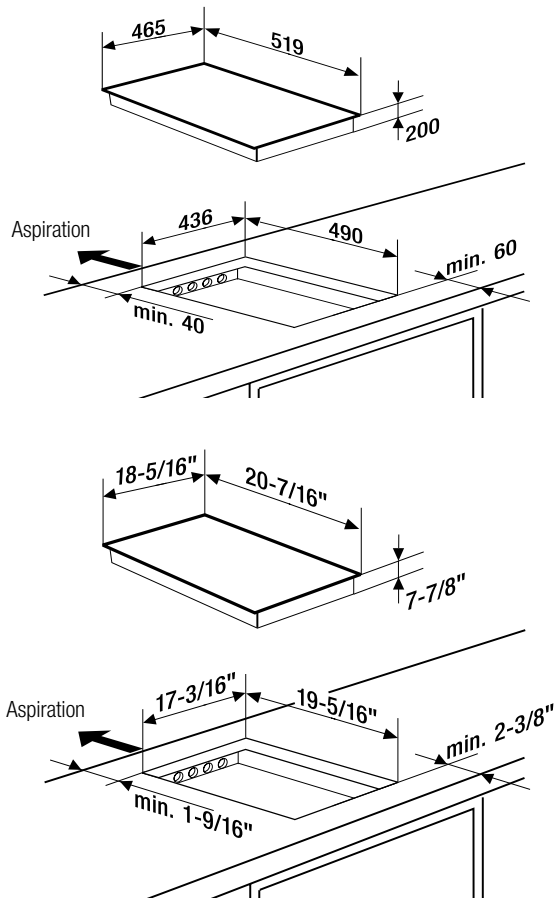

Several cooktops side by side

When installing several cooktops side by side, please observe the minimum distances between the countertop openings as shown in the drawings:

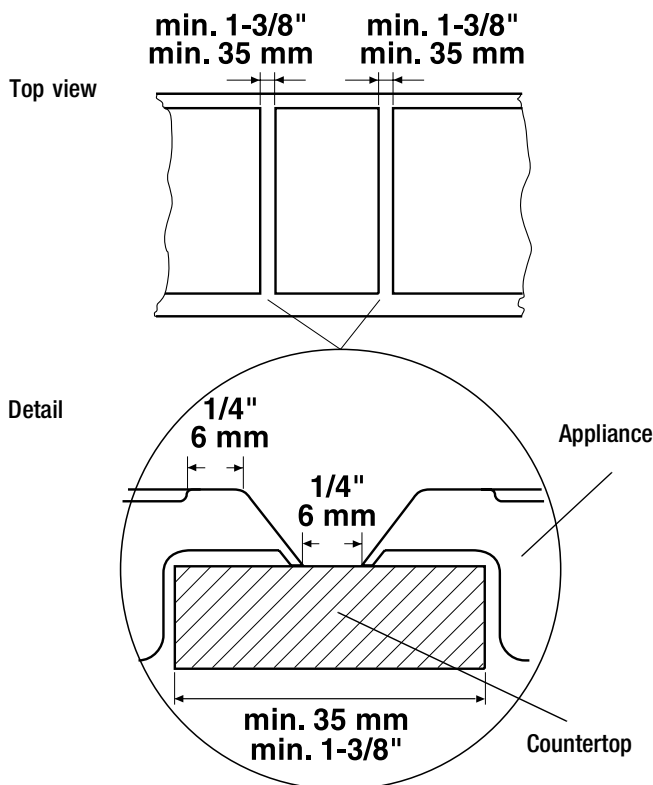

Electrical connection

- Observe all guidelines and regulations from your local electric company.
- You should not be able to touch insulated components when operating the appliance.
- The power supply should be a 240 volts system, 2-wire with ground, or a 120/240 volts system, 3-wire with ground.

Electrical diagram for a 240 volts system, 2-wire with ground:

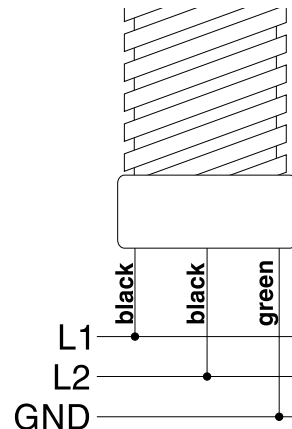

Electrical diagram for a 120 / 240 volts system, 3-wire with ground:

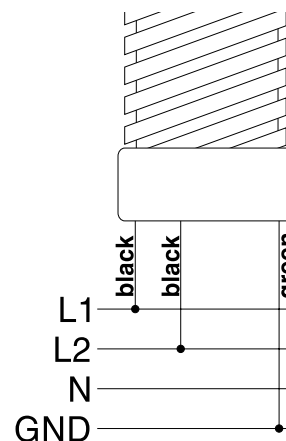

- Be sure to install an appropriate conduit box (not furnished) to connect the cook top. Only a professional electrician or certified technician should install a conduit-box or replace the connection cable.
- Don't shorten the conduit to facilitate service! The conduit should be routed to permit the removal of the cooking surface.
- The conduit-box must be protected by a circuit breaker or fuse, having amperage as noted in this chapter.
- The conduit-box can be mounted under the countertop below the cooking surface or in a side cupboard in the wall. Do not mount it above the cooking surface!

Connection to a conduit-box (not supplied accessory!)
 Total rating EWI 457.1 3.5 kW, fuse current: 20 A
 Electrical connection 240 V, 60 Hz

Installation

- When installing stone worktops the hob cannot be fastened with clips. See page "Special case: Installing in a stone work surface" page 6.

Cutting-out the opening

- First neatly cut out the worktop opening. The distances of the opening to the wall for the front, the back and the side have to be observed!
- Insert ventilation slits in the back wall of the cupboard, at least 150 cm² (24 inches²). (see dimension drawing).

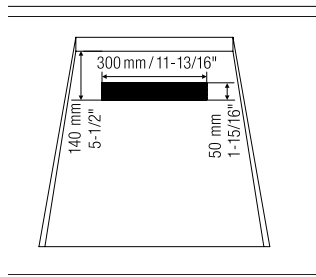
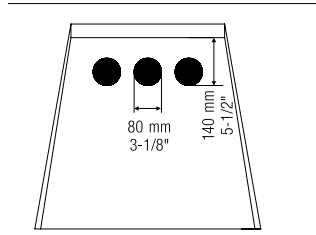

Seal the cut sections

- The cut sections should be sealed with a water-repellent protection paint.

Checking or replacing the sealing

- Check that the seal fits well and has no gaps.

With uneven worktops(for example tiles) you have to remove the sealing strip and apply a temperature resistant and elastic sealant.

- Clean the surfaces according to the instructions, apply the sealant and press the appliance into the opening.
- Remove excess sealant by cutting and clean the sealed surface immediately with water.

Drive in the clips

- Align the clips carefully and drive them in with a hammer.

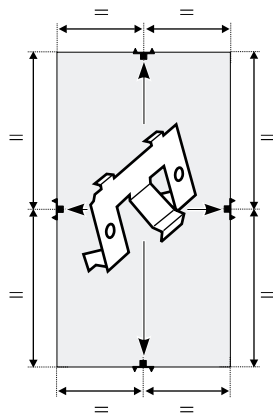
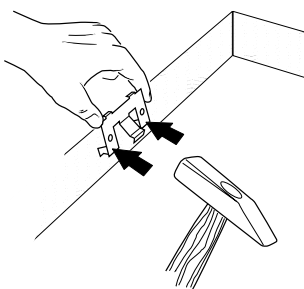

Worktops with more than 30 mm (1-1/8") thickness:

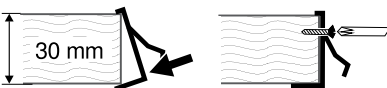

With workingtops with 30 mm (1-1/8") thickness the clips have to be screwed down with two screws (not supplied)!

Insert the clips of the hob

- Position the grilling surface on the left side (1), align it (2) and insert the clips (3). Be careful not to pinch the connecting cable!

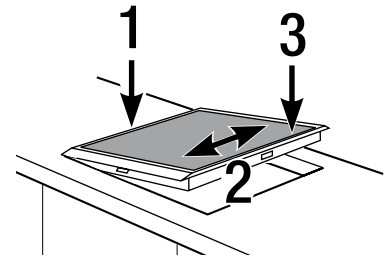

- The hob must rest evenly in the opening. If the strain of the hob is too great the appliance can crack when heating up.

- If the hob is not fixed tightly in the opening it is slightly too big. In this case screw the clips with two screws down each (not supplied) to raise the spring tension.

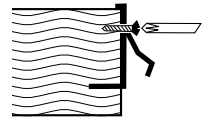

Alignment of the air channel

- Slightly loosen the screws of the air channel.
- Push the air channel under the hob to the rear against the back wall.
- Fasten the air channel with screws from below.

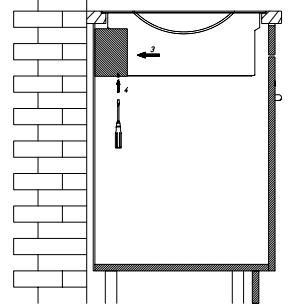
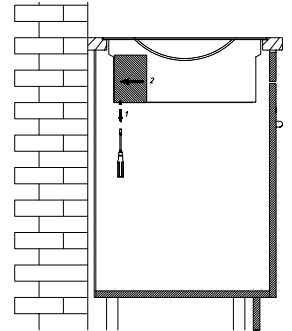

Plug the mains plug into the wall socket.

- Insert the plug into the wall socket.
- The exceeding cable has to be pulled out of the installation area.

Installation above a cover plate:

- Install the cover plate in the mentioned installation depth of at least 220 mm (8-11/16") (at least 20 mm (13/16") under the floor pan).

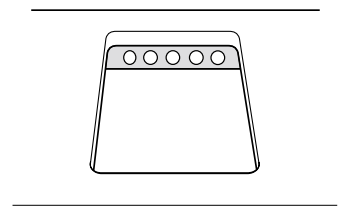

Special case: Installing in a stone work surface

With a working surface made of marble, granite or similar material, the clips are not screwed to the cut-out but to the hob.

for 30 mm (1-1/8") work surfaces

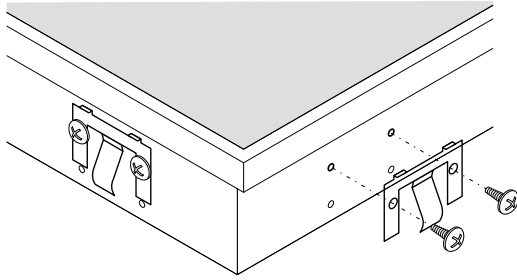

for 40 mm (1-9/16") work surfaces

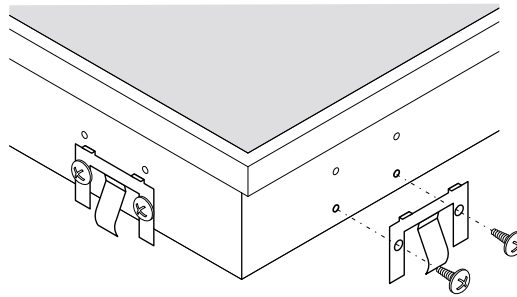

– Insert the cooking area surface edge at the back and carefully lower it. Use manual pressure on the clips here.

– Press the cooking area surface down until it is entirely in contact atop the working surface.

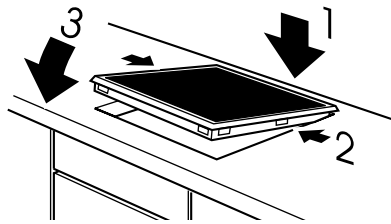

☞ If the cutout in the work surface is a little too big it is possible to bend the clip retainers outward to increase spring tension.

KÜPPERSBUSCH USA

4920 West Cypress Street, Suite C
Tampa, Florida 33607

Telephone: 813-288-8890 Fax: 813-288-8604

Customer Care line: 1 - 800 - 459 - 0844

www.kuppersbuschusa.com

KÜPPERSBUSCH IS A BRAND OF TEKA USA, INC.

Küppersbusch

EXTRAORDINARY KITCHENS BY DESIGN